

**External venetian blinds from Griesser.**

Lamisol® III, Solomatic® II und Aluflex®,  
Grinotex III und Metalunic V  
Embedded guides for  
thermal insulation systems



**Technology in detail**

- 1 Standard reveal element with aluminum insert
- 2 Prefabricated for Griesser Products Lamisol® III, Solomatic® II, Aluflex®, Grinotex® III, Metalunic® V
- 3 Guides, Fix F, Fix L, Type G, Type M and conventional Type E
- 4 Secure fastening of guide to aluminum insert
- 5 Defined water drainage
- 6 Standard skirt
- 7 Standard window sill

**Example with Griesser Lamisol® III:**

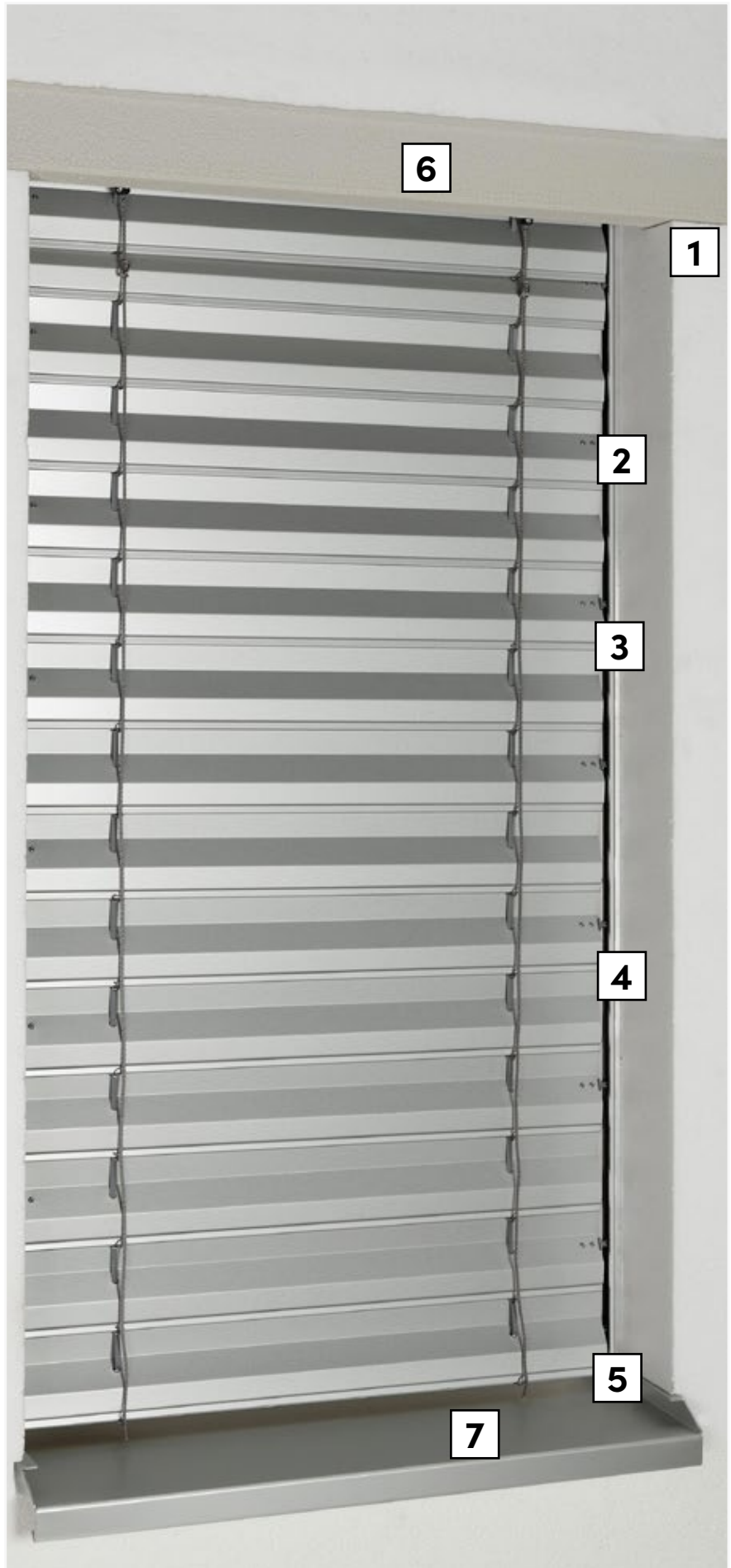

Available prefabricated for Griesser external venetian blinds Lamisol® III, Solomatic® II, Aluflex®, Grinotex® III, Metalunic® V by Dosteba.

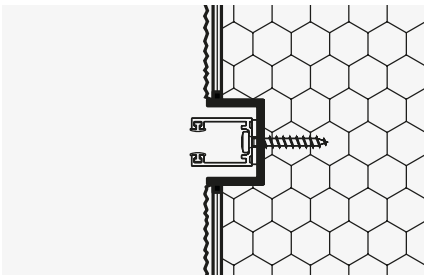

Aluminum insert to securely fasten the guide. No fastening in insulation / on rondels.



No damage to building because of defined water drainage.

## Basic building process



### Griesser

Griesser consults with architects and customers for embedded guide solutions.

### Designer / Insulation installer

Plan the insulation elements by the designer or the insulation installer (with Dosteba assistance).

Plan the insulation elements by the designer or the insulation installer (with Dosteba assistance).

Order insulation elements through insulation installer (with Dosteba assistance).

Griesser performs measures for external venetian blinds.

Griesser mounts the external venetian blinds.



## Construction procedure in detail

### 1.

Indicate advantages of the solution

Define opening (windows or doors)

Record window height **hl**

Record window width

Select product

Check limit dimensions against **hl** and **bk**

### 2.

Determine product data

Determine header height **hs** from **hl** (table)

Determine niche depth **tn**

Determine guide type

Determine drive type

Articulated crank: Establish left or right

Motor: Provide introduction of the electric conduit

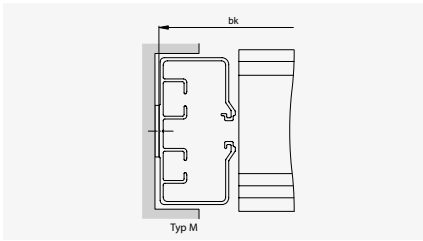
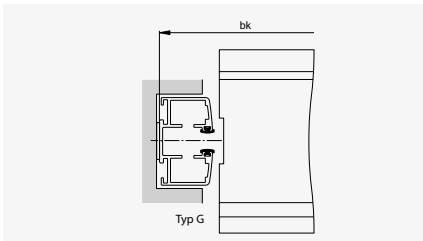
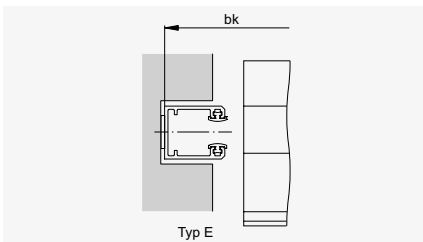
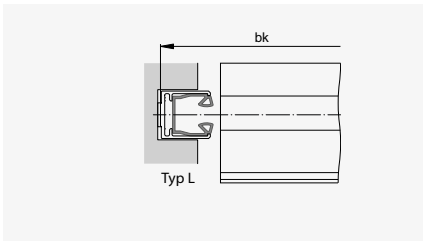
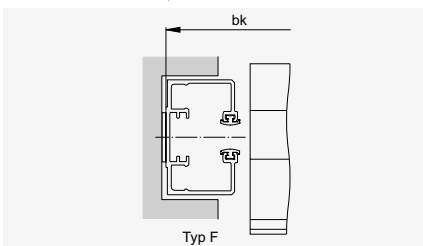
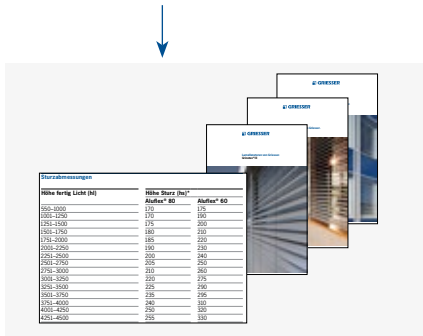
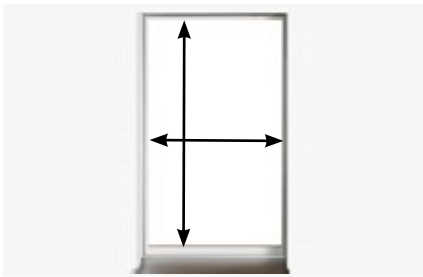

### Product

### Guide type

Lamisol® III 90 Fix

Solomatic® II 80 Fix

Aluflex® 80 Fix

**Type F / Type L**

Lamisol® III 70 Fix

Solomatic® II 70 Fix

Aluflex® 60 Fix

**Type F / Type L**

Lamisol® III 90

Solomatic® II 80

Aluflex® 80

**Type E**

Lamisol® III 70

Solomatic® II 70

Aluflex® 60

**Type E**

Grinotex III

Metalunic V

**Type G**

**Type M**

Version:

Standard: motorized



Option: with articulated crank drive



### 3.

Order Dosteba insulation element through insulation installer using Dosteba order form.

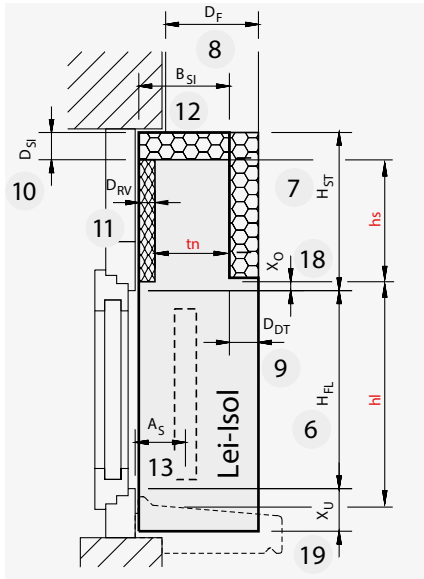

### 3.1

Dosteba order form

Order sizes

$$H_{ST} = h_s + D_{Si} + X_o$$

$$B_{Si} = t_n + D_{RV}$$

$$A_s = t_n / 2 + D_{RV}$$

Guide "Griesser Typ F" / "Griesser Typ E" / "Griesser Typ L"  
"Griesser Typ M" / "Griesser Typ G"

### 3.2

Order from Dosteba

additional specifications in accordance with internal Dosteba price list

Order Lei-Isol for Fix clips for guide type F, L, M and G with cutout in the reveal element (1).

Order general profile welded underneath (2).

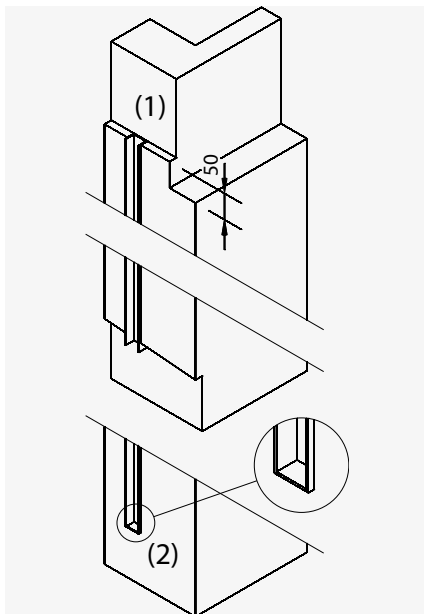

### 4.

Install insulation elements by insulation installer.



Additional note:

For articulated crank drive, provide lateral niches if possible (note drive side and gearbox position).

### 5.

Measurements for blinds: Window height  $h_l$ , width of construction  $b_k$ , height of package  $p$ .

Note:

#### Separated guides

For easy installation, two-part guides with continuous beading should be ordered only for Type F and Type G.

#### Light at the bottom

If the guides are not flush with the window ledge (standard), they can be ordered with a negative extension (guide extension  $V =$  e.g.  $-25$ ). This reduces the amount of light at the bottom

### 6.

Installation of blinds by Griesser.

# As information for the installation installer.

Bitte kopieren / copier s.v.p

**Dosteba**  
*Les éléments sont notre point fort*  
**Elemente sind unsere Stärke**

Bestellformular / Bulletin de commande **7904**

**Elementensystem Lei-Tab**  
**Système d'éléments Lei-Tab**

SYSTEM  EPS WEISS  EPS GRAU  SW  RaV-Isol® StU-Isol  PU

Verarbeiter: \_\_\_\_\_ Objekt / Objet: \_\_\_\_\_  
 Entrepreneur: \_\_\_\_\_  
 Sachbearbeiter: \_\_\_\_\_  
 Responsable: \_\_\_\_\_  
 Tel.: \_\_\_\_\_  
 Fax / E-Mail: \_\_\_\_\_  
 Systemhater: \_\_\_\_\_  
 Op. du système: \_\_\_\_\_  
 Datum / Date: \_\_\_\_\_  
 Visum / Visa: \_\_\_\_\_

Tel. avis.: \_\_\_\_\_  
 Liefertermin: \_\_\_\_\_  
 Date de livraison: \_\_\_\_\_

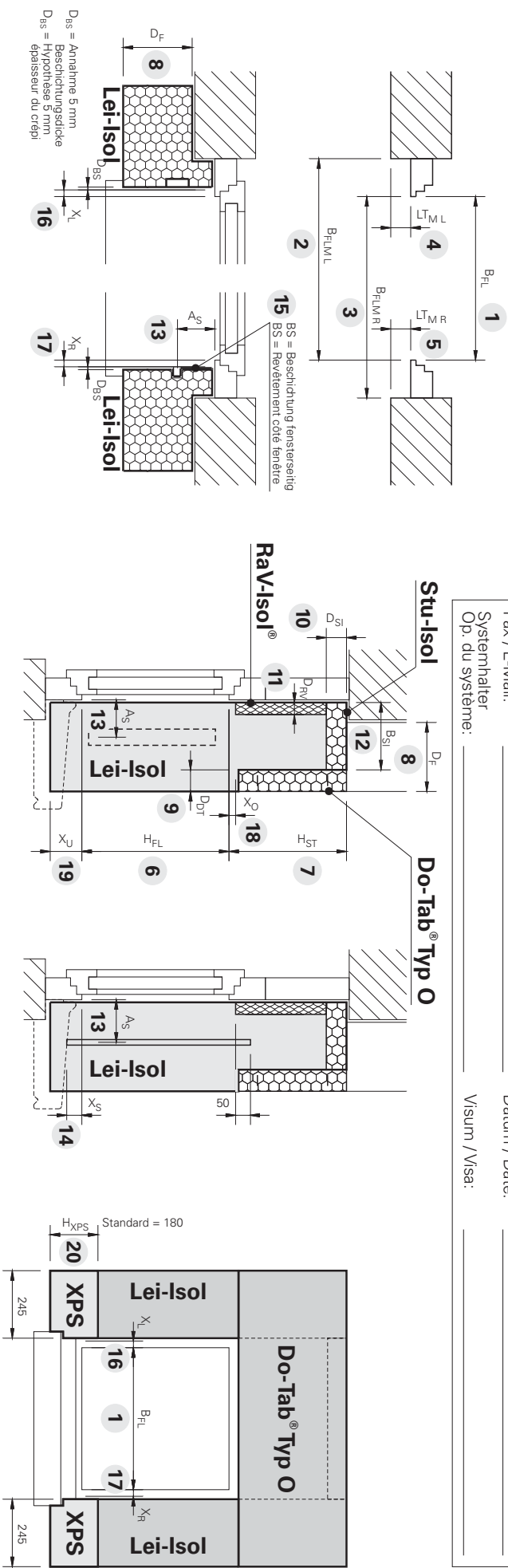

Pos.	Anzahl Fenster / Nombre de fenêtres	Horizontallement	Vertikal	Masse	Bezeichnung	Standard	Bemerkungen
	Rahmenlicht Vide du cadre	B <sub>RL</sub>	H <sub>RL</sub>	D <sub>RT</sub>	Schienenabstand / Par rails de guidage jusqu'au rail	Standard 100 mm	Sockelanschluss XPS / Raccordement de la plinthe XPS
		B <sub>FLWL</sub>	H <sub>ST</sub>	D <sub>SI</sub>	Bei versenkten Störstreifen / Jusqu'au crépi fini façade	Standard 180 mm	Grösser / Typ E/F
		B <sub>FLMR</sub>	D <sub>F</sub>	D <sub>RV</sub>			
		L <sub>TL</sub>	D <sub>ST</sub>	B <sub>SI</sub>			
		L <sub>TR</sub>	D <sub>ST</sub>	A <sub>S</sub>			
			H <sub>FL</sub>	X <sub>S</sub>			
			H <sub>ST</sub>	B <sub>S</sub>			
			D <sub>ST</sub>	X <sub>L</sub>			
			D <sub>ST</sub>	X <sub>R</sub>			
			D <sub>ST</sub>	X <sub>O</sub>			
			D <sub>ST</sub>	X <sub>U</sub>			
			D <sub>ST</sub>	H <sub>RS</sub>			





**Your partner:**

Griesser solar shading - Quality since 1882.  
[www.griessergroup.com](http://www.griessergroup.com)

